



On the RIVER



*Connecting ALVA Florida
NEIGHBORS and
NEIGHBORHOODS*

Ken DeWalt, publisher-editor

TO SUBSCRIBE or offer articles (maximum 300-500 words) or to send jpeg photos of Alva area happenings, or to contact the publisher/editor with any questions, email Ken DeWalt, kendewalt1@gmail.com

The deadline for receipt of any materials is the 15th of the month previous to the month you wish the articles to run. Issues go out before the 1st of each month. I do not take advertising at this time. Please understand that all articles are subject to available space and editor's approval.

Does your neighborhood need REAL mosquito control? (TY LehighAcreCitizen.com)



The LCMCD serves areas based on service requests. "Any time a citizen feels like they are having mosquito problem they can call the District and request service or submit a service request online. There is no cost for service requests," said Jackson.

The LCMCD sprays what is called Naled. According to the Florida Department of Agriculture & Consumer Services, "Naled, sold under the name Dibrom when applied in accordance with the label, can be used to kill mosquitoes without posing unreasonable risks to human health or the environment."

The district also uses sentinel chickens as a tool to monitor for potential viruses mosquitoes may carry.

"The sentinel chicken program serves as a valuable surveillance tool to monitor for mosquito-borne viruses," said Jackson. "The District maintains sentinel chicken flocks across the county as well as an additional supply of birds kept at the District. The sentinel chicken serve as a sampling tool to monitor for the active transmission of diseases within the wild bird population. This form of proactive disease monitoring is conducted by testing samples of chicken blood on a bi-weekly bases. The District tests all samples in house as well as sends an additional sample to the state laboratory for confirmation and official record keeping. If a sample is confirmed as positive the nearby area will be scheduled for treatment to suppress further disease transmission."



LCMCD also uses unmanned aerial systems as "emerging technology that can effectively and efficiently augment mosquito control operations. From surveying aquatic habitats where mosquito larvae grow to performing prescribed treatments to breed sites, drones are a helpful tool in the District's mission to protect public health."

Residents can call LCMCD at 239-694-2174 or can submit a service request online at lcmcd.org.



ALVA Nascar racer Ross Chastain wins at Daytona on July 5 (TY NBC Sports)

Ross Chastain held off teammates Justin Haley and AJ Allmendinger to win Friday night's rain-delayed Xfinity Series race at Daytona International Speedway.

It is the first NASCAR win for Kaulig Racing in 125 combined Xfinity Series starts since 2014. It is Chastain's second career Xfinity Series win.

"Oh my gosh, we did it!" Chastain told NBCSN. **"I sat here as a kid. I watched these races as a kid every Fourth of**

July, never could come in the spring because we were growing watermelons. These guys right here gave me a race car that, oh my gosh, could win a race at Daytona!"

AND at the end of July Ross won at Pocono for the third truck series win of the season.



Lehigh Acres hospital builds mental health center for SWFL patients

(TY Wink News, Reporter: Channing Frampton, Writer: Jack Lowenstein)

Lehigh Regional Medical Center is undergoing construction to provide mental health services by adding a new behavioral health center in its facility.

"Depression is a significant issue affecting the aging population," CEO Gary Bell said. **"Hopefully, we will help those people."**

Christina Devault personally knows the toll mental illness can take on an individual. **"It runs in my family,"** Devault said. Devault is a patient herself. **"I've been dealing with mental illness for half of my life,"** Devault said.

Devault advocates for access to mental health care in Southwest Florida. And this is a challenge the hospital in Lehigh is also taking on. **"We're going to dedicate an entire floor of the hospital for that purpose,"** CEO Gary Bell said.



When the outpatient center is completed, it will have 35 beds and feature group therapy, art therapy and drug and alcohol education. All the services will be provided specifically for people 55 and older. **"What we're noticing is that younger people don't have the stigma,"** said Linda McKinnon, president of Central Florida Behavioral Health Network.

According to the National Institute of Mental Health, suicide is the eighth leading cause of death for people 55 to 64 years old.

McKinnon is working to get more money for services like the ones coming to Lehigh, especially as views on mental illness evolve. **"It is a brain disease,"** McKinnon said. **"There's nothing to be ashamed about. We need to fight stigma."** This is something Bell plans on doing once the center is up and running. **"We believe there's a significant need,"** Bell said.

The plan is to have the center in Lehigh operational by December, and services are not limited to people in Lee County. The hospital said it will take patients from all over Southwest Florida and will also accept Medicare and Medicaid patients.

OFFICE OF THE LEE COUNTY HEARING EXAMINER
ORDER GRANTING REQUEST TO REOPEN HEARING
BOLAND FAMILY GOLF DRIVING RANGE – SEZ2019-00009

On July 11, 2019, the record was left open for Parties to submit written materials to the Hearing Examiner, specifically;

1. Revised conditions, specially additional conditions addressing consumption on premises and right-of-way buffers; and
2. Revised Special Exception Site Plan depicting location of private lessons.

On July 23, 2019, the Hearing Examiner received Staff's written materials. After review of the submitted material, the Hearing Examiner requests that the Parties be prepared to clarify the revised conditions at the hearing scheduled **AUGUST 1, 2019, at 9:00 A.M.**

Public participants from the July 11, 2019 hearing may provide additional testimony at the August 1, 2019 hearing. Members of the public who did not participate in the July 11, 2019 hearing will not be permitted to testify.

The August 1, 2019 hearing will be limited to clarification of revised conditions, public testimony and rebuttal by the applicant.

ORDERED on July 25, 2019.

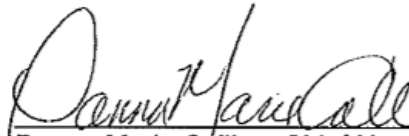

Donna Marie Collins, Chief Hearing Examiner for
Timothy Jones, Hearing Examiner

Office of the Lee County Hearing Examiner
P. O. Box 398 (1500 Monroe Street, Suite 218)
Fort Myers, Florida 33902-0398
Telephone: 239/533-8100

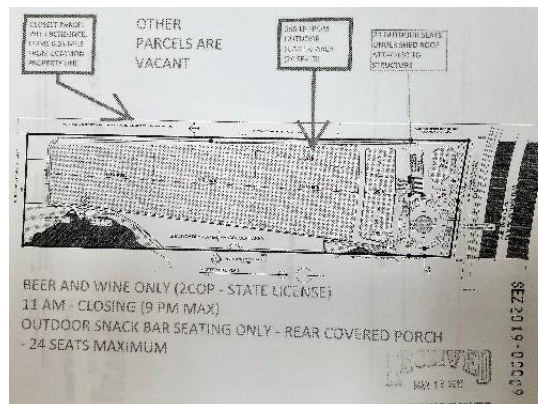

The Firehouse Community Theatre in LaBelle has another great line-up for their 27th Season!



"Four Old Broads" (Comedy)

Nov 1, 2, 3 & 7, 8, 9, 10

"A Nice Family Christmas" (Not your traditional Christmas Comedy)

Dec 6, 7, 8 & 12, 13, 14, 15

"Nunsense" (Comedy/Musical)

Jan 10, 11, 12 & 16, 17, 18, 19

"Butterflies Are Free" (Comedy)

Feb 7, 8, 9 & 13, 14, 15, 16

"'til Beth Do Us Part" (Comedy)

March 13, 14, 15 & 19, 20, 21, 22

"A Murder Has Been Renounced"
(Mystery)

April 17, 18, 19 & 23, 24, 25, 26



firehouse
community theatre
inc.

241 North Bridge Street, Labelle, Florida

www.firehousecommunitytheater.com

863-675-3066



Feeding America releases the 2019 Map the Meal Gap study

Study shows children in Southwest Florida are more likely to face hunger than children nationwide

Summer may be a joyful season for many, but this time of year poses a triple threat for the Harry Chapin Food Bank. During the summer when schools are closed, jobs decline, and produce is scarce, we need the most support.

Today, 46,470 children in Southwest Florida rely on free or reduced-price school meals for breakfast and lunch. But now that school has ended, these children will lose those regular meals—greatly increasing their risk of going hungry.

Summer's Triple Threat

- No School
- Fewer Jobs
- Little Produce

Help us overcome summer's triple threat to feed children and families in our community.

To make a donation, call (239) 334-7007 or visit harrychapinfoodbank.org.



Friends of Okeechobee Waterway West

Dedicated to preserving and enhancing the natural and recreational resources of The Okeechobee Waterway

Our second organizational meeting will be held at the Franklin Lock South Visitor Center on July 11, at 7:00 pm.

Our first step is to develop a first-year plan to be submitted to the Corps. Secondly, develop a board. Thirdly, obtain our 501 c non-profit and develop a web site and brochures. We will be conducting events at this park including Halloween, Christmas and Easter.

Contact Bev MacDonald at friendsofoww@gmail.com for more information.

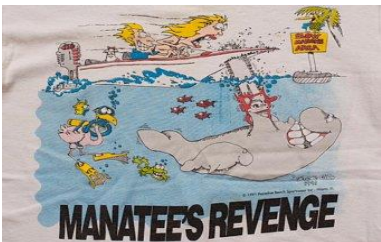



Services available for all of ALVA at Charleston Park Community Center

2541 Charleston Park Dr. Alva, FL 33920

Contact LASHAY RUSS for information

Charlestonpark1926@gmail.com

239-728-8895

Charleston Park Community Center has started a new

CHILDREN's & YOUTH LIBRARY

You've donated books BIG TIME! Now we need more shelving! If you have used **bookshelves** in GOOD condition, or can contribute dollars so we may purchase new, PLEASE DO!



You can help them develop this new library of new and as-new books by donating funds or books directly to Ramona or the Center or through the ongoing Charleston Park GOFUNDME website here:

<https://www.gofundme.com/charleston-park-alva039s-children-amp-youth-library>

ALVA INC

Striving to Keep Alva RURAL



ALVA INC meets every second Tuesday of the month at 7pm at the Alva Community Center.

We discuss items pertinent to our community, families, schools, and homes.

Join us to learn what's happening, and how you may be a part of what's happening as Lee County Grows eastward toward our country haven.

One of Alva INC's professional sponsors: **COUNTRY CARE PET SITTING, 863-610-1607**



Wet Walks for the Public

The Friends of the Six Mile Cypress Slough Preserve are again hosting off the boardwalk strolls along the wet walk trail usually closed to the public.

Six Mile Cypress Slough, Lee County Park

7751 Penzance Boulevard, Fort Myers, FL. 33966

The invigorating, beautiful path is immersed in the watery heart of the Slough. Group size is limited to 16. You must be at least 10 years old to participate because of the possible water depth.

Dates - all on Saturdays. Walks are only conducted during the wet season.

August 10 10 am and 1 pm

August 24 10 am and 1 pm

September 7 10 am and 1 pm

September 21 10 am and 1 pm

October 5 10 am and 1 pm

October 19 10 am and 1 pm

Reservations required. Contact Charles O'Connor at rcoc77@embarqmail.com



Manatee Park, 10901 Palm Beach Blvd, Fort Myers, FL 33905

The park kayak launch is closed for the season but there is an alternate launch at the park with direct access to the Orange River. This launch is open to the public with paid parking. You will need to walk your paddlecraft about 390 ft to access this location. The launch closes daily at 4:30 p.m. Few manatees are seen as the weather warms up.

Pavilion, Chickee Hut & Amphitheater Rentals are available to rent. Call (239) 690-5030 ext. 222 or email HGienapp@leegov.com for reservation information. Picnic areas are available first come, first serve.

Olga Community Park

2325 S Olga Dr, Fort Myers, FL 33905

(239) 533-7275



The Olga Community Center was built in 1927 and was used as a schoolhouse until 1939. In 1952, the Lee County School Board sold the building to a non-profit group called Olga Community Center Inc. In 1964, Olga Community Center Inc. turned the center over to Lee County and in 1986, Parks & Recreation assumed operational control. The center has retained its historic feel and continues to serve the local community. In 2008, the center underwent a total historic renovation. New flooring and windows were installed back to the historic floor plan of the 1930's.

Olga Community Park was the play area of the Olga Community School in 1927. The park has provided outdoor space for the local residents ever since. The current playground was installed in Spring 2007.

Hickey's Creek Mitigation Park

17980 Palm Beach Blvd, Alva, FL, 33920



- Great for quiet creek kayaking.
- Fun for walks and picnics.
- A pond overlook.

The acquisition of lands to form Hickey Creek Mitigation Park (HCMP) started in 1994. Adding to 10 acres of land already preserved, Lee County's Environmentally Sensitive Lands Program and Florida Communities Trust purchased 770 acres. Five parcels, totaling 82 acres, were acquired through the Conservation 20/20 program. HCMP was opened to the public on April 20, 2002, making this a natural area for all to enjoy. HCMP encompasses 862 acres of land consisting of pine flatwoods, scrubby flatwoods, freshwater marshes, cypress swamps, hardwood hammocks, and oak-palm forests. The Tourist Development Council of Lee County assisted in the funding of waterfront facilities at Hickey Creek. The creek flows through HCMP for over 1 mile and discharges into the Caloosahatchee River. Hickey Creek is also part of The Great Calusa Blueway Paddling Trail. The terrestrial and aquatic communities within HCMP support a variety of wildlife including gopher tortoises, Florida Scrub-Jays, Florida panthers, bobcats, eastern indigo snakes, American alligators, river otters and a variety of birds.

W.P. Franklin Lock & Dam South Recreation Area

Franklin Lock Rd. , Alva , FL 33920. Contact: (239) 694-2582

WP Franklin South Recreation Area is a day use area located on the Caloosahatchee River adjacent to the WP Franklin Lock and Dam. Visitors can watch boats traversing the 152 mile Okeechobee Waterway that spans South Florida from the Atlantic Ocean to the Gulf of Mexico, enjoy the exhibits at the visitor center or just relax with a picnic lunch.



Lock usage: Operating hours 7 a.m. to 5 p.m., 365 days a year, unless otherwise noted in the Coast Guard published, "Notice to Mariners." Lockage usually takes 15 to 20 minutes.

This day use area has a visitor center, boat ramp, volleyball and horseshoe courts, a playground and several covered picnic sites. Flush toilets and drinking water are also available. There are two group picnic shelters available for reservation. Each shelter has water and electricity, six picnic tables, a large charcoal BBQ grill and can accommodate up to 50 people.

ALVA BOAT RAMP PARK

21580 Pearl St, Alva, FL 33920

Public boat ramp with 15 parking spots. Parking fee is \$5 per day.
Lee County Parking Stickers are valid at this location.

Parking fills up early on weekends.



Alva Community Center PARK

21471 North River Road, Alva, FL 33920 , (239) 728-2882

Three of the many activities here:

Girl Scouts , Community Meetings, AA meetings every Wednesday



The Alva Community Center is part of the Alva Community Park, behind the Alva Middle & Elementary Schools. Lee County acquired the 5-acre property in 1966. In the early 70's the center was home of the first Alva Fire House and community gathering place. The building was completed by the efforts of volunteers and concerned citizens. This building was completely renovated in 2004. It has one large meeting room, two small rooms, one computer lab with six computers, and one kitchen.

Caloosahatchee Regional Park

19130 North River Road, Alva, FL 33920 (239) 694-0398



EMAIL: leeparks@leegov.com

Shelter rentals, primitive tent camping, Horse and bike trails.

Purchased by the State of Florida in the 1960's, Lee County Parks & Recreation entered into a lease on the site in 1989 with a management agreement to provide public recreational opportunities. Per the lease agreement with the State, the Park is managed, "only for the conservation and protection of natural and historical resources and resource-based, public outdoor recreation which is compatible with the conservation and protection of these public lands."

This park features 768 acres of pine flatwoods, scrub oak, cypress swamps, and oak hammocks. Crossing through them, you'll find over 20 miles of hiking, mountain biking, and equestrian trails. The north side of the park is designated for mountain biking and horseback riding. The south side of the park has hiking trails, fishing pier, a floating dock, and the primitive campground. Primitive camping sites for families and groups are available, along with equestrian sites for people with horses. Kayaking and fishing are available along the banks of the Caloosahatchee River. Covered pavilions are available for group use or special events.

Located along the Caloosahatchee River, it is an area rich in natural history. Calusa Indians are believed to be the first settlers here, followed by Seminole and early settlers of what is now known as Alva. Early studies have also found two archaeological sites within the park. The efforts of several community members from the Caloosa Saddle Club in 1985 were instrumental in convincing Lee County Commissioners to proceed with plans to develop a park. Along with other groups such as the Florida Mud Cutters Mountain Bike Club, volunteers were instrumental in the development of the trail system on the park's 400-acre North side. Caloosahatchee Regional Park opened on March 6, 1999 and to this day Lee County volunteers are instrumental in trail maintenance and campground management.

2017-2018 Fichter's Creek Restoration Project provides ecosystem restoration and flood protection for neighboring areas through hydrologic and water quality improvements in Fichter's Creek. This restoration project will also improve habitat value for native plants and animals at Caloosahatchee Regional Park. The purpose of this project is to improve the water quality within the creek system and to relieve some of the flooding that occurs within developed portions of the watershed. This will be accomplished by constructing wet and dry detention ponds, including control structures, within the Caloosahatchee Regional Park and creating a filter marsh in the existing manmade ditch. Attention will also be given to regrading the berm between the proposed filter marsh and Fichter's Creek Lane to the west, filling existing breaches, and reconstruction of existing berms to block breaches between the park, the creek, and the filter marsh. For more information, call CRP Supervisor James Eash at 239-694-0398

NORTH FORT MYERS Recreation Park

2000 North Recreation Park Way

North Fort Myers, FL 33903



Disc Golf Course

This park features an 18 hole Disc Golf course For more information call (239) 297-8916.

League Partnerships

Pop Warner: (239) 997-4900

Babe Ruth Baseball: (239) 995-7011

Shuffleboard: (239) 997-2797

Looking for something to do this summer?

Here's the shortlist from our two Rec Center Parks:



35+ Basketball, Adult Basketball 18 +, Ageless Grace, Art Social, Badminton, Bluegrass Jam, Bridge Card Socials, Ceramics, Chess Club, Club Rec, CPR Certification, Crochet, Double Pinochle Card Social, Euchre Card Social, Family and Friends CPR Instruction, Gentle Yoga, Hand & Foot Card Social, Hawaiian Dance, Jazzercise (Low Impact), Karate, Line Dance, Mahjong, Meditation, Open Basketball, Personal Trainer, Pickleball, Rummikub, Strength Training, Table Tennis, Tai Chi, Total Body Conditioning, Youth Basketball, +

Veterans Park Recreation Center

55 Homestead Road South

Lehigh Acres, FL 33936



Club Rec Registration begins May 13th. Please be sure to update your household memberships.

Adult Pickleball has been added to the Wednesday night lineup from 6:15-8:45 p.m.

Fort Myers MEALS ON WHEELS wants to begin their wonderful service to homebonds of any age in ALVA!



Would you enjoy delivering a couple meals a week as a volunteer driver?

Do you know someone who could use some meals prepared and delivered ready to eat at their home?

NOW taking applications for both!!

Contact ROSE..... see below>>

Our caring Meals on Wheels volunteers provide daily, nutritious home-delivered meals and a friendly, safety and security check to eligible homebound neighbors who cannot shop or cook for themselves. These neighbors include seniors, the disabled, or chronically ill adults under the age of 60.



To become a volunteer driver/deliverer to clients, or to become a client receiver of meals and other services, please contact:

Rose Goree-Lawrence, Admin. Asst., PO Box 2143, Fort Myers, FL 33909 or call her at 239-337-1055 or email her at Rose@CommunityCooperative.com

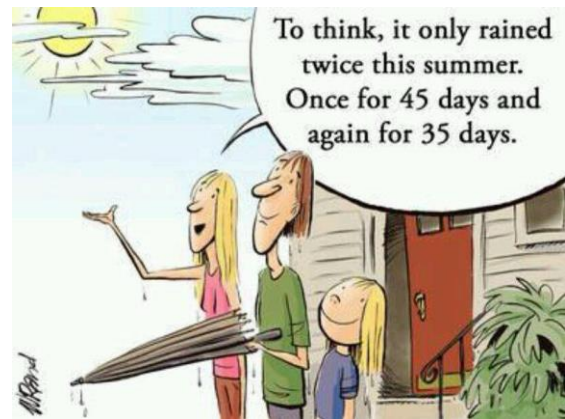
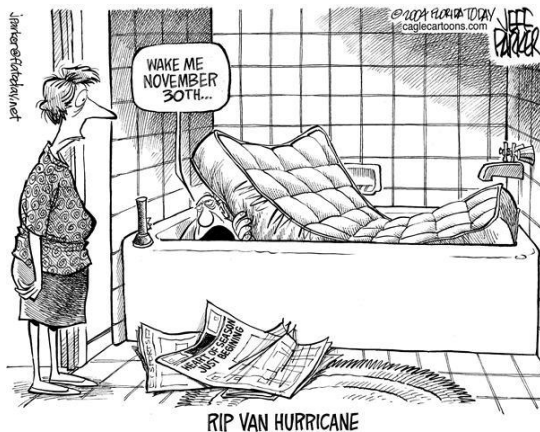

Some of our local ALVA area churches:

St. Vincent DePaul's RC Church

13031 Palm Beach Boulevard, Fort Myers, FL 33905

www.stvincentftmyers.org

239-693-0818

Alva United Methodist Church

21440 Pearl St. P.O Box 96

Alva, FL 33920

Alvamc@embargmail.com

239-728-2277

Alva Church of God

21520 Park St, Alva, Florida 33920

239-728-2644

Liberation International Church

Avenue D, Charleston Park

Alva, FL 33920, 239-601-4870

**Charleston Park Community
Center**

FOOD PANTRY.

Every 2nd and 4th Thursday at
10am-2pm

ALVA UMC

Food Pantry @ Bethany House

Food Pantry: 9am-12pm 1st & 3rd Wednesdays

Bread Pantry: 8am-10am 2nd & 4th Wednesday

First Spanish Assembly of God Church

2219 Joel Blvd, Alva, FL 33920

239-728-5440

Countryside Wesleyan Church

17750 Palm Beach Blvd, Alva, FL 33920

239-368-3270

Calvary Church

19850 Palm Beach Blvd

Alva, FL 33920

www.calvarychurchswfl.org

239-728-5566

First Baptist Church of Alva

2790 Joel Blvd, Alva, FL, 33920

www.alvabaptist.com

239-728-2034

Grace Church, Ft Myers Shores

14036 Matanzas Drive, Ft Myers, Florida 33905

www.egracechurch.com

239-694-2797

To have your church listed here simply contact me, Ken DeWalt, at kendewalt1@gmail.com with as much contact info as you can share.

St. Vincent DePaul RC

Our Lady's Cupboard Food Pantry

Breakfast cereal and canned fruit continue to be needed in Our Lady's Cupboard Food Pantry. Call (239) 694-3985 for hours open.

A bit of ALVA History

The founder of Alva



Alva today is a charming, rural, unincorporated area of Lee County, Florida. A drive through Alva reveals extensive citrus groves, pastures dotted with cattle and horses, houses, some grand, most modest, nestled beneath majestic live oaks, dripping with strands of Spanish moss, and a small village perched upon the banks of the Caloosahatchee River. Alva has a long and rich history, being one of the first settlements in Southwest Florida.

The "modern" history of Alva began with the vision of a Danish sea captain by the name of Peter Nelson. A colorful character that homesteaded a vast area, platted and laid out a village, earmarking plots for schools, parks, churches, even the first library in South Florida. In fact, he convinced then 'Monroe County' officials at the county seat of Key West to build one of the first schools in the entire county (now comprising all of Monroe, Collier and Lee Counties).



He called his town "Alva," naming it after the profusion of small white flowers growing along the bank of the same name. Captain Nelson was instrumental in the forming of Lee County, and served as one of its first County Commissioners.

From the official records of the Alva United Methodist Church: "Captain Peter Nelson, a Dane, acquired a tract of land on the north side of The Caloosahatchee... he decided to build a city, so had a map made of his property, streets named, lots designated for a church and other public building, etc. A tiny white flower spread over the earth, so the Captain, a botanist as well as a navigator, accepted the name which nature (and the Danish language) supplied, and called his town "Alva." The Alva



Flower, White Sabatia (*Sabatia brevifolia* Rafinesque), is a native member of the Gentian family.

The good captain was plagued by rumor. Because some said he brought with him to the area a hoard of jewels it was thought he might be an illegitimate son of the Danish King. He was accused of drunkenness and removed from what many considered good work on the now Lee County School Board. He died in modest, if not destitute, means, and is buried, on Pine Island.



Most of the information and pictures are taken from "The Benevolent Dane" by Charles Edgar Foster.

Copies are available at Alva Museum.



JUST BE KIND

Polly Kiely of Alva was inspired to begin an Alva sign movement when she learned of a Central Indiana youth project started in 2015. The message is a gentle reminder that may impact positive interactions with others and lift one's spirit. Kindness is contagious, and something we can all benefit from. For more information, Google "Just be Kind".

The origin of the JUST BE KIND sign movement:

<https://fox59.com/2018/08/08/just-be-kind-movement-spreading-worldwide/>

To find out more about Polly's local efforts and how you may become a part of them contact Polly at: pbkiely@embarqmail.com

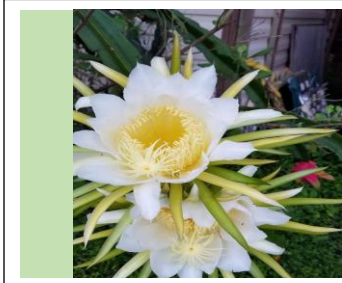

ALVA GARDEN CLUB

<http://www.fmlcgardencouncil.com/council-directory/102/alva-garden-club/>

A visit worth your time!

The ALVA MUSEUM

in the historic Alva Library Building,

one of the oldest library buildings in existence
anywhere in Florida



Over the past year the Alva Museum buildings and grounds have undergone a complete historic

rehabilitation. The museum board and a co-sponsor of the museum's access to the public, the Alva Garden Club, invites you to contact them (see website above) for a private tour of the museum or to visit during open hours, any Saturday afternoon, 2 to 4 pm.





ALVA FIRE CONTROL & RESCUE SERVICE

2660 Styles Road, Alva, Florida 33920. (239) 728-2223

THANK A FIREPERSON

For the service they offer, most often voluntarily!



From your Lee County Sheriff's Department

Agricultural Unit Makes Arrest of ALVA Abusive Horse Owner

On July 3, 2019, the Lee County Sheriff's Office received a call for service regarding possible animal cruelty/neglect.

Members of the Agricultural Crimes Unit were dispatched to the 21000 block of Edwards Drive, just west of Joel Boulevard, in Alva.

The complainant expressed concerns about a malnourished horse on a nearby property.

A Lee County Sheriff's Office deputy located the Paint Mare, a white and brown horse showing signs of malnutrition. Using the Henneke Body Condition Scoring System, which is based upon a visual observation and a manual examination of fat cover over the six major points of the horse, the animal was deemed to be in distress. The scale rates horses from one to nine, one being gaunt and skeletal and nine reflecting obesity. The horse was scored at 2.5.



Additionally, the horse had sores and cuts on the back of the horse's rear legs. A fresh wound on the left side of the horse's head bled and was infested with flies. The horse's hooves were overgrown and cracking and a scar was apparent on the horse's neck.

The owner of the horse, Jose Antonio Gamez Azcanio (DOB 02-04-1948), was located and interviewed. Based on a thorough investigation, which included gathering information from the horse's previous owner, Gamez Azcanio was arrested and charged with violations of Florida Statutes 826.12(1) (Torment/Deprive/Mutilate/Kill an Animal and 588.24 (Permit Livestock to Run at Large or Stray).

"I want to be crystal clear," stated Sheriff Carmine Marceno. "There will be zero-tolerance for ANY abuse in Lee County. If you abuse an animal, we will find you and put you behind bars where you belong."

The horse is currently at the Lee County Sheriff's Office impound yard receiving veterinary care. Gamez Azcanio is in LCSO custody.

Your RIVERDALE LIBRARY



Location:

2421 Buckingham Road
Fort Myers, FL 33905

Directions to Riverdale Branch Library



Hours:

Tuesday (Noon-8 p.m.)

Wednesday and Thursday (10 a.m.-6 p.m.)

Friday and Saturday (9 a.m.-5 p.m.)

Contact: 239-533-4370, Branch Manager: Alyssa Diekman. Closed Sundays and Mondays

For more information, please visit us at leelibrary.net or call 239-479-INFO.



Get Crafty at the Riverdale Branch Library

Did you know that we have craft programs at the library just for adults? Not only are these crafts a fun way to pass the time and meet new people, they're also good for your health! According to a recent article in Harvard Health, "studies have shown that expressing themselves through art can help people with depression, anxiety, or cancer, too. And doing so has been linked to improved memory, reasoning, and resilience in healthy older people."

Interested in giving it a try, but afraid you're not the creative type? No problem! The article goes on to say, "the beneficial effects of creating aren't dependent on a person's skill or talents.

'It's the process, not the product,' says Megan Carleton, an art therapist at Harvard-affiliated Massachusetts General Hospital (MGH)."

The Riverdale Branch Library provides unique crafting opportunities for adults the second Saturday of every month. Please join us on August 10 at 10am to create a beautiful mosaic made out of colorful dyed rice.

Saturday, August 10, 2019, 10:00 AM – 12:00 PM

Design a unique mosaic with dyed rice. All supplies will be provided.

Please note this program is not intended for children under 13.

**LEE COUNTY
EMERGENCY**

& SERVICE CONTACT INFORMATION

ACT-Abuse Shelter (Domestic Violence) 939-3112
 Addiction Services (Salus Care) 332-6989
 Alcoholics Anonymous 275-5111
 Ambulance (emergency) **9-1-1**
 Animal Services 533-3353
 Citizens Dispute (Mediation) 533-2885
 Chamber of Commerce SW Fla. 275-2102
 Child Abuse 800-962-2873
 Child Support Enforcement 877-769-0251
 Clerk of Courts 533-5000
 Code Enforcement 533-8895
 Clear Point Credit Counseling 278-3121
 County Commission 533-2259
 Dead Animal Removal 949-6246
 Division of Motor Vehicles 533-6000
 Dept of Transportation-County 533-8580
 Drug Abuse (Salus Care) 275-3222
 Economic Crimes Unit 258-3240
 Elder Abuse Hotline 800-962-2873
 Elder Helpline United Way 2-1-1
Emergencies 9-1-1
 Fraud Line (LCSO) 258-3287
 Health Department 332-9647
 Humane Society (Gulf Coast) 332-0364
 Lee County Transit (Lee Tran) 533-8726
 Mental Health (Salus Care) 275-3222
 Legal Aid 334-6118
 Libraries 479-4636
 Parks & Recreation 533-7275
 Poison Information Center 800-222-1222
 Probation Office (County) 533-9199
 Probation Office (State) 338-2349
 Public Defender 533-2911
 Red Cross 278-3401
 School Board 334-1102
 School Transportation/Bus Barn 590-4000
 Social Security Administration 800-772-1213
 State Attorney 533-1000
 Suicide Prevention Lifeline 800-273-8255
 Supervisor of Elections 533-8683
 Tax Collector 533-6000
 Veterans Services Office 800-827-1000

Lee County Sheriff's Office Headquarters
 14750 Six Mile Cypress Pkwy
 Ft. Myers, FL 33912 477-1000

North District Substation
 121 Pondella Road
 N. Ft. Myers, FL 33903 477-1810

East District Substation
 1301 Homestead Road North
 Lehigh Acres, FL 33936 477-1820

West District Substation
 15650 Pine Ridge Road
 Ft. Myers, FL 33908 477-1830

South District Substation
 8951 Bonita Beach Road #565
 Bonita Springs, FL 34135 477-1840

Bonita Springs Substation
 10520 Reynolds St
 Bonita Springs, FL 34135 477-1140

Central District Substation
 14750 Six Mile Cypress Pkwy.
 Ft. Myers, FL 33912 477-1850

Gulf Substation 282-5766

Lee County Jail (inmate information)
 2115 Dr. Martin Luther King, Jr. Blvd
 Ft. Myers, FL 33901 477-1500

Civil Process
 2072 Victoria Avenue
 Ft. Myers, FL 33901 477-1353

Lee County Gun Range
 6570 Felix Romano Avenue
 Fort Myers, FL 33905 690-3999

Community Relations 258-3280
Fraud Line 258-3292

Juvenile Assessment Center (JAC)
 2115 Dr. Martin Luther King, Jr. Blvd
 Ft. Myers, FL 33901 344-5100

**FEDERAL, STATE & LOCAL LAW
ENFORCEMENT**

Fort Myers Police 321-7700
 Cape Coral Police 574-3223
 Sanibel Police 472-3111
 Port Authority Police 590-4810
 Florida Highway Patrol 278-7100
 Federal Bureau of Investigations 337-7171
 Drug Enforcement Agency (DEA) 275-3662
 Fla. Department of Law Enforcement 278-7080
 Federal Government Info. Center 800/688-9889
 Fish & Wildlife Commission 863-648-3200



Calusa Waterkeeper is a non-profit organization dedicated to the protection of the Caloosahatchee River & Estuary in Southwest Florida. This includes Lake Okeechobee, Nicodemus Slough, Charlotte Harbor, Estero Bay, plus the near-shore waters of Lee County and their watersheds. We strive to achieve this mission through education and promotion of responsible use and enjoyment by all people.

Join Our Team! Become a Certified Ranger

The Ranger Academy is an educational and training resource for volunteers interested in working with the Calusa Waterkeeper in Southwest Florida. Rangers volunteer as citizen monitors of area waterways and will be trained to conduct surveys and report conditions and observations while on local waters. Volunteers set their own schedules and monitor in project area zones of their choice. Participants should have access to area waters by boat or paddlecraft.

Fall 2019 Session

October/November Dates TBD

Cost is \$40 or membership in Calusa Waterkeeper

Basic water science education

Learn how to monitor water quality

Report water pollution and wildlife observations

Participate in a sea grass restoration project

Training by the Calusa Waterkeeper and local



educators

Graduates receive a certificate and official CWK Ranger hat

No prior experience needed

Classes held at the Calusa Nature Center, Iona House

info@calusawaterkeeper.org

General: (239) 784-0880



Pollution Hotline: (239) 444-8584 (This line is for reporting suspected water quality or wildlife violations ONLY)



7305 FL-78, Fort Denaud, FL 33935

(863) 675-0334



Daughter's of the American Revolution

USS Hannah Chapter NSDAR

National Society

Daughters of the American
Revolution | Alva, Florida

Consider joining your local DAR Chapter

www.usshannahnsdar.org



Named for FIRST US naval warship



Fight for the Light at SR31 and SR78

If you are a concerned resident or worker in Alva, North Olga, Babcock Ranch or North Fort Myers, Florida, please sign this petition and help Fight For The Light!

Sign the petition on here or FACEBOOK now:

www.thepetitionsite.com/960/363/539/fight-for-the-light-at-sr31-and-sr78/

Or call for information: Sue Bisplinghoff, 239 980 2470

What would you like all Alva to know about next month?

Send posters, photos (jpegs only) or articles of 500 words maximum you would like to see printed or contact the editor with any questions,

Ken DeWalt, kendewalt1@gmail.com

The deadline for receipt of any material is the 15th of the month previous to the month you wish the articles to run. Issues go out before the 1st of each month.

Please understand that all articles are subject to available space and editor's approval.

Southwest Florida TIPS

Summer bow hunting (TY Game & Fish Magazine)



Photo by Ron Sinfelt

In southwest Florida, Big Cypress WMA is the best public spot to take a deer with a bow, according to Wes Seitz, public hunting area biologist for the FWC. The Picayune Strand State Forest and WMA (76,000 acres, Collier County) is also good.

To hunt these areas, all a bowhunter needs are standard hunting licenses (WMA, archery and deer permits), for the deer season, which runs Aug. 26-Sept. 17. There are check stations on Big Cypress, where hunters must check in and out, and check harvested game. But check-ins are not required daily, which allows hunters to camp on designated areas for many days and hunt without daily check-ins.

The Picayune Strand State Forest and WMA is essentially a quota hunt spot, except in bow season when there is no archery quota. The area was largely closed to public access as reconstruction of the site was conducted. But much of it is now open, though getting around Picayune can be difficult because vehicles must stick to designated roads and trails, and there are a lot of wetland areas.

Car care in Southwest Florida HEAT (TY Coastal Hyundai)

Washing the Car In Hot Weather: At first thought, it may seem like washing your car in warm, sunny weather would be great for helping it dry, but it can actually be damaging. As you wash, the heat from the sun will dry up water droplets on your car, making it look dirty again and actually allowing the soap to harm the vehicle's paint. Wait until it's cooler at night or just wash your car in the shade.



Another area of your vehicle you should pay attention to is the rubber separating you and your car from the road. Your tires are rubber, and you may have noticed that rubber dries out in the heat. Tires are fairly durable, but over time they can crack or bulge, increasing the chance of a blowout. On top of that, as temperatures rise, air expands. This means properly inflated tires could have an increased PSI that causes them to become overinflated.

Just as the heat can sap the energy out of us, it can do something similar to your car's battery. Extreme heat can cause liquid in the battery to evaporate, which means the parts in the battery won't be as well protected, increasing the risk of you getting stranded somewhere inconvenient. So, what can you do about it. Simply having your battery inspected and tested regularly should be enough to stay on top of this problem.

Lastly, it's important that you consider ways to keep your car (and yourself) cool on the road. There isn't always much you can do, but keeping fluids like engine coolant and oil filled can certainly help. If you think your car may be overheating for some reason, don't risk it. Pull over as soon as it is safe and allow the vehicle to cool down. Then, check your fluids and call for assistance if necessary.



Some of the DeWalt 2019 SUMMER JOURNEY

Last month we showed you a few places we thought you might find interesting as we moseyed up the east coast of Florida, Georgia and South Carolina, then headed west through North Carolina and West Virginia.

Since then we've been bouncing around Central Ohio, Indiana, Illinois, Iowa, Nebraska, Colorado and Southwestern Utah.

We come home to Alva by the first of September through the south, and we thought you might enjoy some of these places we've discovered as we AirBnB it around our beautiful North American continent!



-Springfield, Ohio, is a nice town to visit or live in without the Hartman Rock Garden, but with it, you get a piece of America's coal mining legacy, a story of hidden creativity let loose, and the bond of a town's people with their past.

Ben Hartman was an out of work laborer in 1932 when he just could not sit still and let the great depression depress him any longer. So he built a little stone water pond in his back yard. And the rest, as they say, is waiting for you to see at no cost, thanks to the citizens of Springfield, Ohio. Ben died of black lung disease in 1944 and his wife carried on the free tours till she passed.



-Indianapolis, Indiana, has lots of sites to see and races to run, but if you are looking for a down right AMERICAN meal you want to head off the beaten track, and out on some beat streets to Belvue Avenue. That's where working, or not, hungry people have been finding some the finest flat grilled, well done American double cheeseburgers with ALL the fixin's,



Begun in 1918 Lou Stamatkis began serving what the factory guys and commuters off the nearby trolleys and trains wanted. Cheap, GOOD, food.

The name of the place began as the 'Belvue Lunch', but when the depression hit, and his customers began to ask for meals on credit till pay day, Lou said yes. And his customers changed the name of the bar/restaurant to what it is today: THE WORKINGMAN's FRIEND. Don't miss the good food or the friendly Stamakis service when you next hit Indy for any reason.



-Route 66, the first paved highway across the country (Chicago to LA) and called The Mother Road by John Steinbeck in his book Grapes of Wrath, begins about 60 miles north of Pontiac, Illinois, in the heart of Chi-Town.

But here in Pontiac is the largest museum and memorial to this iconic highway.

Everyone comes here! The bikers in the photo at the left are from Manchester England and they are rolling the entire road over several weeks on rented machines. This is the America



GI's told their English dad's and mum's about when training for D-Day all over the south of England in 1944. They flew the pond to get their kicks, on Route 66.



-What do you think of when you hear of Moline, Illinois? Unless you are a farmer you might think of nothing at all. But farmers all over the world think of JOHN DEERE, and the largest harvester works in the world.



A tour of the plant is free but you really need to sign up online and days ahead. The riding and walking tour is over an hour long and you receive a true, steel part cutouts to painting to assembling to testing tour.

The unit I show here is the latest and largest edition, with front tracs, Full GPS control of as many as 5 other harvesters and their paired tractors and wagons for receiving the harested grains. The asking price for a fully loaded unit like this is over \$800,000.00. I was told a recent transient company, which moves its units by oversize trucks from Mexico to Canada each year following the seasons just bought 27 of them. I imagine they got a bit of a discount.



-I'm guessing that all these years after his last movie was filmed in 1976 (The Shootist, about a gunman dying of cancer), and his death of stomach cancer soon after (yes, he knew he was dying. It's why he made the film) there are plenty of persons not just old enough but much younger who know who you mean when you mention "The Duke".

Did you know he got the nickname as a boy in Winterset, Iowa, where he was born, because his huge airedale terrier, Duke, followed him everywhere he would go? Wayne's birth name was Marion Robert Morrison; May 26, 1907 – June 11, 1979.



Today you can visit his birth home, and a sizable museum about his life in films and far beyond in Winterset, IA.



-Some folks think Boys Town was just a 1939 movie starring Spencer Tracy as a Catholic Priest names Father Flanagan. Some think Boystown used to exist but only in the distant past. And some think Boys Town is just for boys. Anyone who thinks any of these things is dead wrong.

We toured the soon to be CITY of Boy's Town on a quiet summer afternoon. We learned that it was started in a small building in downtown Omaha, Nebraska in 1917 by that Father Flanagan guy. WE learned that from several boys he got to know and pulled in off the street the town located west of Omaha has its own huge post office, hospital, fire company and police force. And instead of dormitories for its boy and girl students (since 1979) there are dozens of 'family' homes qwith married home 'parents' for every dozen or so kids (one gender per home- no coed).



He ain't heavy; he's my brother

WE also learned that Boys Town will soon be called a city! Begun several years ago and scheduled for completion in the mid 2020's, the remaining area Father Flanagan bought, called South Farm, when he moved out to the country from the city in 1927, will expand the student body to twice its current 400, and will house a senior community as well. A lot of those BT alumni want to come home to Boys Town when they retire.



-About 35 miles from downtown Denver, Colorado, is one of the coolest, and for some the scariest, paved mountain roads up a fourteener (peak over 14,000 ft) you can climb. WE did it in our CRV with five adult kids and we all came back alive!

If you come to Colorado, don't miss the more often mentioned front range sites like Pikes Peak and Rocky Mountain National Park. But please put this ride on your itinerary. The peak is open

24 hours a day, IF it's not snowed in. Yes. The photo above was taken on July 11 at the summit, and that is snow at 49 degrees farenheight; though it melted on contact.

Mule deer, elk, mountain goats and sheep, marmots, chipmunks, to see up and back. Moose are here, but we saw none this day.



-The Grand Staircase-Escalante National Monument in Southwest Utah has beautiful canyons, wind and water formed majesty, distances longer than you can imagine. It also has a historic stretch of road called Utah 12 that when it's final portion was paved in 1940, from Boulder to Escalante put the last mule train US Mail delivery in the nation.



However, despite a few upgrades to this road since 1940, there are still places like the one pictured to the left where the highway is all there is between two deep gorges. And its GORGEOUS!



Sadly the current administration recently announced that oil, gas and mining interests will now be allowed to access this beautiful land. Often called the last real west left, I'm so glad we got to visit before much damage is done.

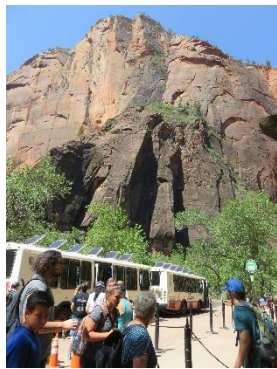

-Zion National Park was dedicated into America's National Park system in 1919. In the last 100 years Zion has become one of the most visited National Parks in the nation. So many visitors come here that the main attraction, Virgin River Canyon, may only be entered on foot or by LPG powered shuttle busses in peak seasons.

All private automobiles, campers, bikes and motorcycles must be parked at the park entrance, which fills up early each day. Therefore the town of Springdale, at the west entrance station to the park, offers PAID parking lots and roadside meters for up to several miles from the park entrance gates, and FREE shuttle busses with many stops all along the main street, Utah Rte 9, to take you to the park entrance and the free park busses.

Nonetheless, with all the crowding, visitors come back sometimes annually just to enjoy the splendor of this very special place. Let the pictures do the explaining as to why:

